

## IN-VEHICLE REPAIR

### Oil Pump

#### Removal

1. Disconnect the battery ground cable. For additional information, refer to Section 414-01.
2. Remove the engine front cover and crankshaft sprockets. For additional information, refer to Timing Drive Components in this section.
3. Remove the oil pan. For additional information, refer to Oil Pan — Automatic Transmission or Oil Pan — Manual Transmission in this section.
4. Remove the oil pump.
  - Remove the bolts.
  - Remove the oil pump.

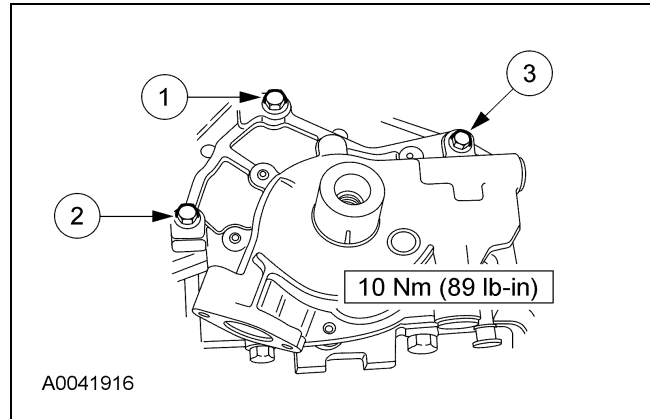
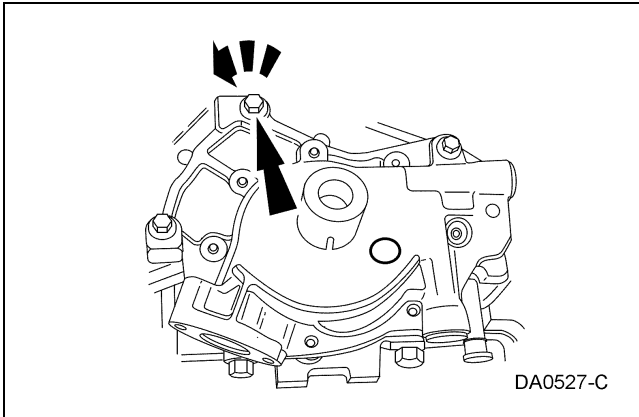

3. Install the oil pan. For additional information, refer to Oil Pan — Automatic Transmission or Oil Pan — Manual Transmission in this section.
4. Install the timing chain. For additional information, refer to Timing Drive Components in this section.
5. Connect the battery ground cable.

#### Installation

1. Clean and inspect the mating surfaces.
2. Position the oil pump and loosely install the bolts. Tighten the bolts in the sequence shown.